

## GEROtherm<sup>®</sup> installation system

---

The versatile and flexible devices  
and adapters for the sinking of GEROtherm<sup>®</sup>  
geothermal probes

## GEROtherm® PUSH-FIX push device

PUSH-FIX as a push device and weight connector for the sinking of single and double-U GEROtherm® geothermal probes with linkage support M16.

The proven GEROtherm® PUSH-FIX push device are available for all geothermal probes of the types **DUPLEX**<sup>1)</sup>, **VARIO**<sup>1)</sup> and **FLUX** with a diameter of 32mm to 53 mm and in the versions -**REX** und -**RT**. The PUSH-FIX push device has performed particularly well in flush boring applications.

The GEROtherm® weight components can be combined in a simple manner. This guarantees flexibility when sinking GEROtherm® geothermal probes in boreholes on the construction site.

For single-U, GEROtherm® geothermal probes



For double-U, GEROtherm® geothermal probes



For double-U GEROtherm® **FLUX** geothermal probes



Maximum pushing force 2000 kg and maximum load-bearing force: 500 kg<sup>2)</sup>



**+** Flexibility with the use of the GEROtherm® weight system. PUSH-FIX de 40 mm in combination with the GEROtherm® extension weight.

- 1) There is no PUSH-FIX solution for DUPLEX and VARIO de 50 mm. However, the weight adapter for double-U and single-U is available (see next page).
- 2) Maximum tensile force based on test using the HakaGerodur tensiometer fixture at 20°C. The dynamic tensile forces on the construction site must be taken into account accordingly. Refer to technical manual for notes on installation.



QR-code with link to our assembly video

## GEROthem® UNI-FIX and weight connector

UNI-FIX and weight connectors are available for all geothermal probes of the types **DUPLEX**, **VARIO** and **FLUX** with a diameter of 32mm to 53 mm and in the versions **-REX** and **-RT** and serves for universal weight attachment. With additional mechanical securing similar to the GEROthem® weight system, the probe U-bend are hold together offset at the optimum distance. The hinge pins are pre-installed and are supplied. The weight connector ensures offset probe base installation and reduces the required installation diameter of the double-U geothermal probes. The UNI-FIX weight connector is also available without additional mechanical securing by the hinged pins.

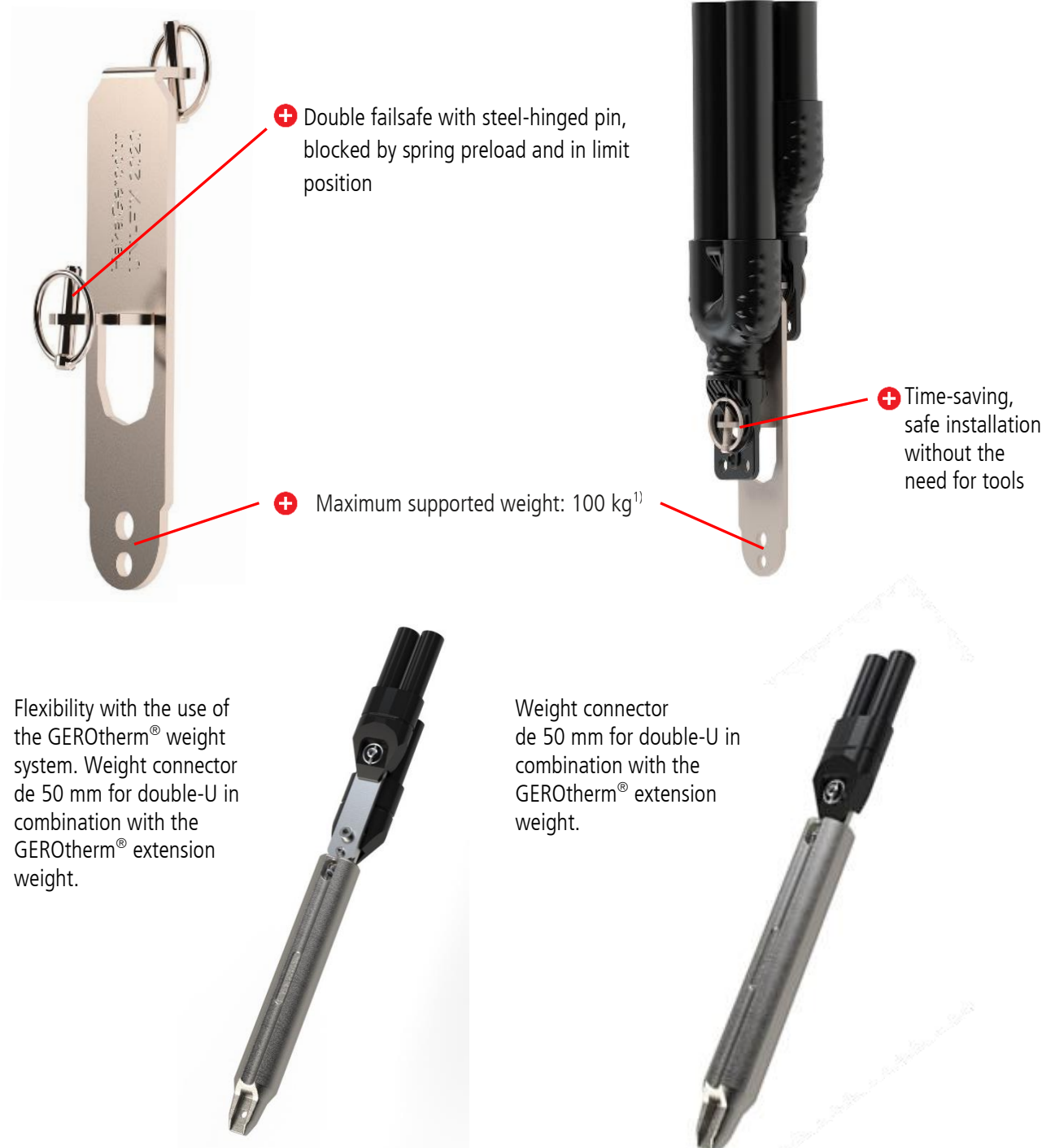

<sup>1)</sup> Maximum tensile force based on test using the HakaGerodur tensiometer fixture at 20°C. The dynamic tensile forces on the construction site must be taken into account accordingly. Refer to technical manual for notes on installation.

## INTERFACE suitable for the GEROtherm® PUSH-FIX push device

The GEROtherm® PUSH-FIX push device with M16 thread ensures the safe use of an installation rod and is very proven in case of high buoyancy due to water. Matching transition to the push linkage with the coordinated **INTERFACE**.

### INTERFACE guide piece for holding push linkages

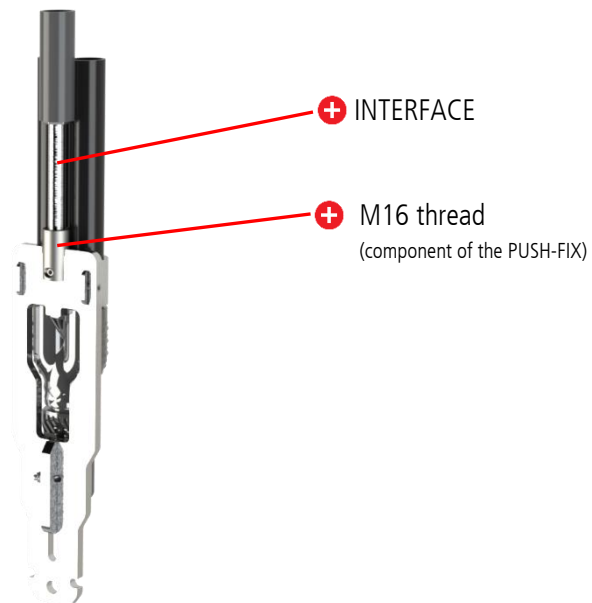

### Scope of delivery/dimensions: INTERFACE

